

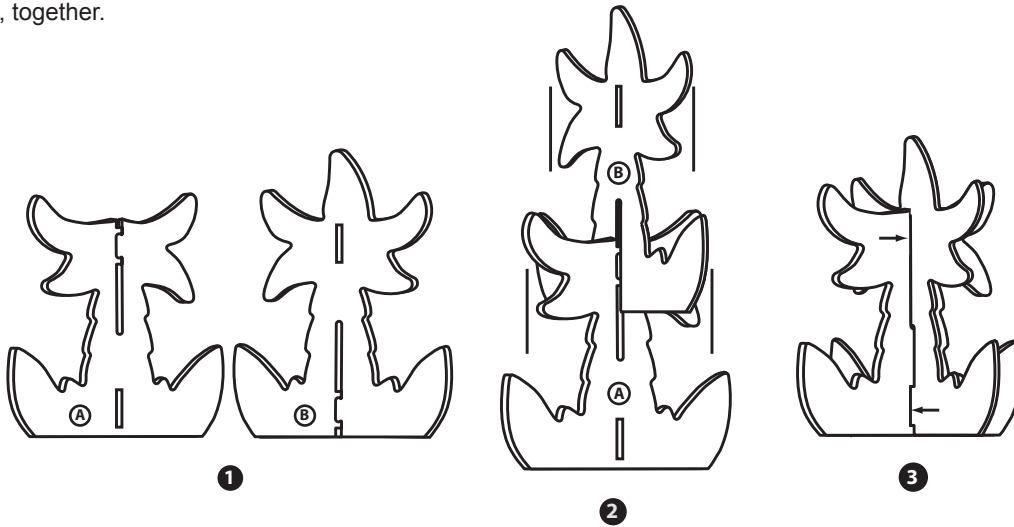

GET READY!

Ready to monkey around? Okay! First, you're going to need to set up your Monkeying Around palm tree. Slide the two halves of the tree together as shown and lock them in place by pressing the tabs on each side, on the top and bottom, together.



GET SET!

Find a good play area where rings can be tossed without interference. Depending on players' skill level, designate a "throw line" behind which players will toss their rings. Don't step over the line!

Keep a chalkboard or pad and pencil handy to keep score. Decide what order players will take their turns in and how many total turns will be taken. Set up a chart for keeping score.

GAME SCORE CHART

	PLAYERS			
	Alex	Susan	Jack	Megan
1st Turn	4	5	3	6
2nd Turn	3	7	1	4
3rd Turn	5	3	2	9
4th Turn	9	4	4	3
5th Turn	2	6	8	5
Total Score	23	25	18	27

winner!

GO BANANAS!

You're ready to start monkeying around. Each player's turn consists of 4 tosses of the monkey rings. Rings that land on any of the numbered sections of the tree score that number. Rings that miss or fall off are not worth any points. At the end of each player's turn, the total points scored for that turn should be recorded on the score chart. Once all turns are taken, the player with the most points wins!

#718

